

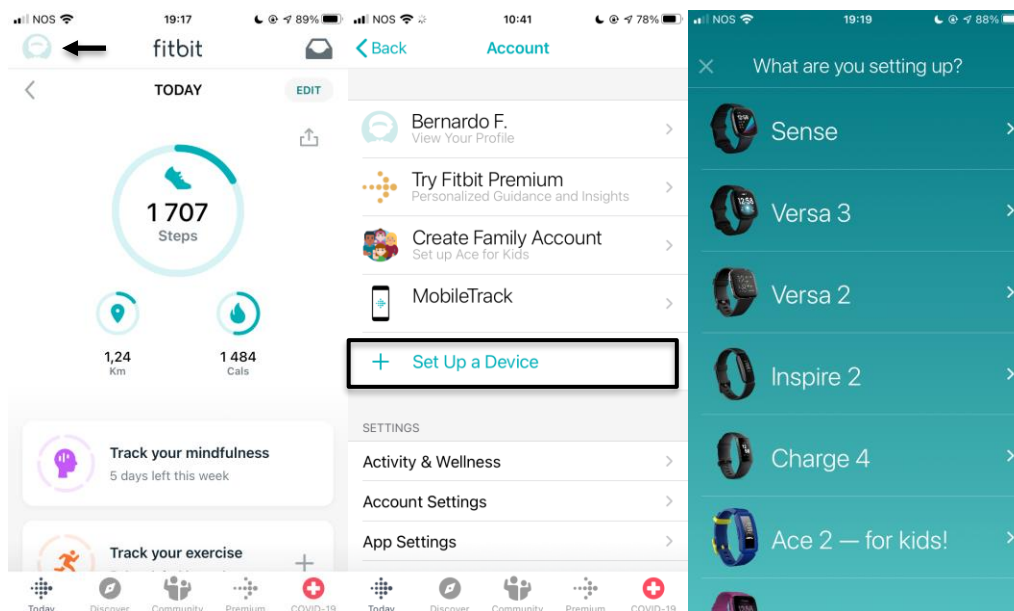

Fitbit devices that connect to the Fitbit app can connect to UPNDO through Google Fit for Android users and Apple Health for iPhone users. This connection between UPNDO and the native Health app on your phone, requires a third party app (Power Sync for iOS, and FitToFit for android).

First, you need to download Fitbit app on your phone and pair it with your Fitbit wearable. Fitbit app can be downloaded from Google Play Store for Android users and App Store for iPhone users.

1. Click "profile", in the top left corner. Click "Set up a device" and select your device.
2. Bring your Fitbit device close to the phone.
3. Follow the instructions on your phone in order to pair your Fitbit device.





Done pairing?

Then, follow the instructions below:

Directions for Android Users

Please note: You must already have the Google Fit app downloaded and an active account in existence before completing these steps. Google Fit is available from the [Google Play Store](#).

To connect FitToFit with Google Fit:

- 1. Install FitToFit from Google Play Store. Set up your account by logging in to your Fitbit account inside FitToFit;**

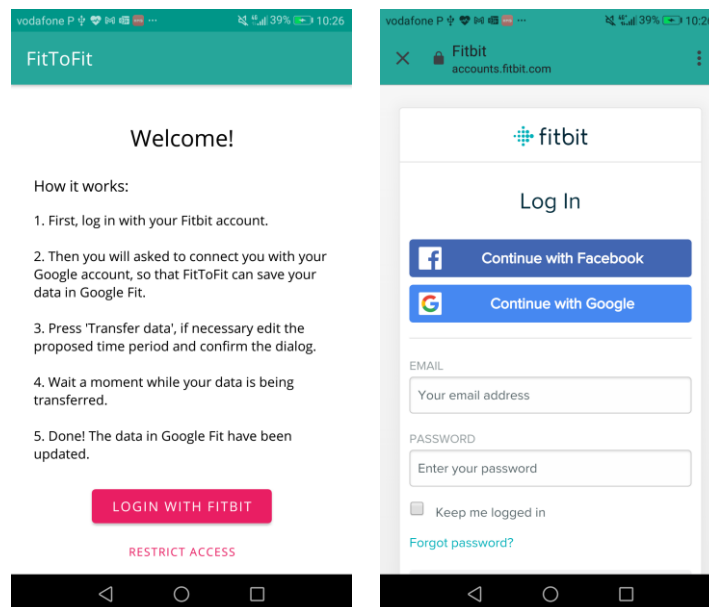



2. Allow Fitbit to share its data with FitToFit;

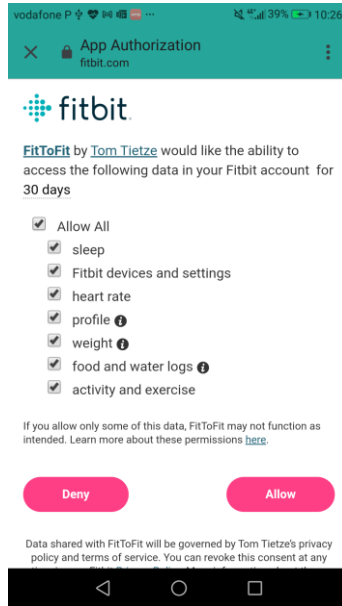

3. Select your Google Fit account to which Fitbit's data will be synchronized and allow the connection, making sure all activity data will be transferred;

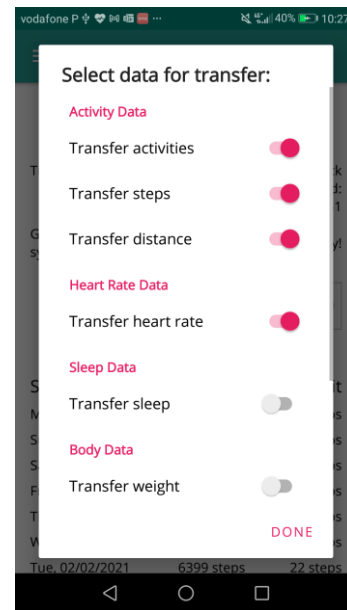
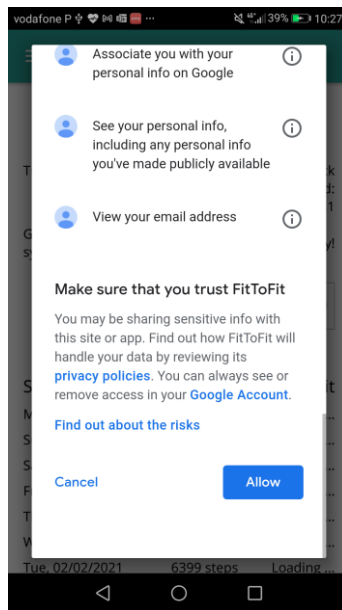
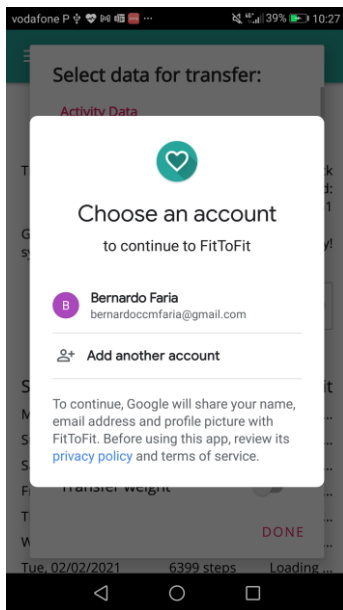



4. Enable AutoSync, so that data is automatically transferred without needing manual intervention.

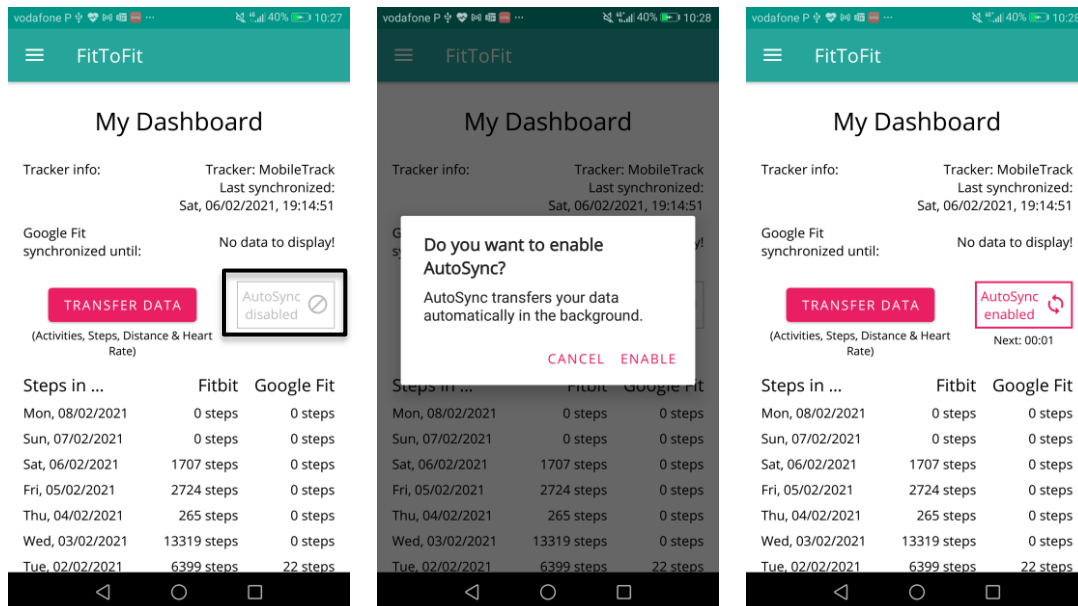



Directions for iPhone Users

1. Install Power Sync, open the app and click “Sync Now”;

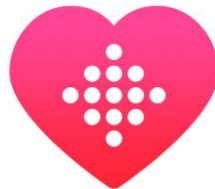
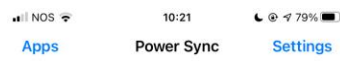

Sync Now

Authorization failed

2. Login to your Fitbit account;

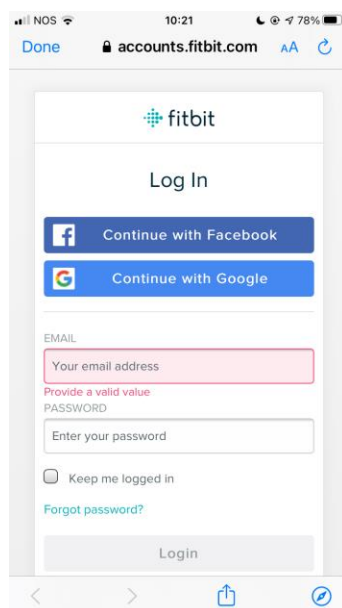



3. Click “Turn All Categories On”, in order to allow PowerSync to both read and write data on Apple Health. Unfortunately, Power Sync requires a paid subscription to have automatic transfer of data. So, each time you wish to synchronize Fitbit with Apple Health you will have to do it manually.

